

# BLOODHOUND R19D

## *Installation Instructions*



## Table of Contents

Required Tools & Accessories .....	2
Battery and Router Installation.....	3
Connection: .....	7
Final Assembly.....	12
Operational Setup .....	14
Battery Operation and Safety Guidelines .....	17
Disclaimer .....	18
Support Contact & Version # .....	18

# Required Tools & Accessories

The following tools (not provided) are required in for the installation of the Bloodhound case antenna:

- Philips Screwdriver
- 11/32" Wrench

The tables below list the required accessories for the Bloodhound case antenna.

	Bloodhound R19DB		Bloodhound R19D	
	Bloodhound R19DB		Bloodhound R19D	
Provided with Antenna	<ul style="list-style-type: none"> <li>• PTA0351 Black Oval Head Screws with Washers, 21 pcs</li> <li>• PTA0399-TL Pan Head Screws, 7 pcs</li> <li>• PTA0757 Pan Head Screws, 4 pcs</li> <li>• PTA0140 Washers, 4 pcs</li> <li>• PTA0844 Lock Washers, 4 pcs</li> <li>• PTA0408 Nuts, 4 pcs</li> <li>• Ethernet Cords, 4 pcs *</li> <li>• USB-A Cord *</li> <li>• Surge Protector</li> <li>• Battery Tray for OmniCharge Ultimate+ Battery Pack</li> <li>• Router Plate for Cradlepoint R1900 &amp; RX30 Managed Accessory</li> <li>• Right-Angle Extension Cord, 3 FT</li> <li>• LED Display Cover, 2 pcs</li> <li>• Cable Ties</li> <li>• PTA1182 OmniCharge Ultimate+ <b>Custom</b> Battery Pack (OP2FPA01)</li> <li>• PTA0746 65W GaN Charger for OmniCharge Battery</li> </ul>		<ul style="list-style-type: none"> <li>• PTA0351 Black Oval Head Screws with Washers, 21 pcs</li> <li>• PTA0399-TL Pan Head Screws, 7 pcs</li> <li>• PTA0757 Pan Head Screws, 4 pcs</li> <li>• PTA0140 Washers, 4 pcs</li> <li>• PTA0844 Lock Washers, 4 pcs</li> <li>• PTA0408 Nuts, 4 pcs</li> <li>• Ethernet Cords, 4 pcs *</li> <li>• USB-A Cord *</li> <li>• Surge Protector</li> <li>• Battery Tray for OmniCharge Ultimate+ Battery Pack</li> <li>• Router Plate for Cradlepoint R1900 &amp; RX30 Managed Accessory</li> <li>• Right-Angle Extension Cord, 3 FT</li> <li>• LED Display Cover, 2 pcs</li> <li>• Cable Ties</li> </ul>	
To be Purchased By Customer	<ul style="list-style-type: none"> <li>• USB-A Cord **</li> <li>• Ethernet Cords, 4 pcs **</li> <li>• Router Options for Bloodhound R19D:</li> <li>• Cradlepoint R1900 with RX30 Managed Accessory, <b>requires 12V 2x3 Power Supply (Cradlepoint #170870-000)</b></li> </ul>		<ul style="list-style-type: none"> <li>• PTA1182 OmniCharge Ultimate+ <b>Custom</b> Battery Pack (OP2FPA01)</li> <li>• <a href="#">PTA0746 65W GaN Charger for OmniCharge Battery</a></li> <li>• USB-A Cord **</li> <li>• Ethernet Cords, 4 pcs **</li> <li>• Router Options for Bloodhound R19D: <ul style="list-style-type: none"> <li>• Cradlepoint R1900 with RX30 Managed Accessory, <b>requires 12V 2x3 Power Supply (Cradlepoint #170870-000)</b></li> </ul> </li> </ul>	

\* For connecting the router to the ports on the case

\*\* Optional, for connecting external devices to the case, length as required by customer

# Battery and Router Installation

Step 1: Mount the OmniCharge 38K Battery Pack to the Cover Plate (**Bloodhound R19D only**).

- A. This step has already been performed for the **Bloodhound R19DB**.
- B. Cut and remove the flaps from the sides of the battery pack, shown in Figure 1.
- C. Insert the battery pack into the battery tray, as shown in Figure 2.
- D. Secure the Battery Tray with the Qty. 3 PTA0399-TL screws, as shown in Figure 3.



*Figure 1: Remove the flaps from the sides of the battery.*



*Figures 2-3: Insert the battery pack into the battery tray and secure the Battery Tray.*

## Step 2: Mount the router to the Managed Accessory

- A. Turn the R1900 over and remove the sticker covering the connector port as shown in Figure 4:

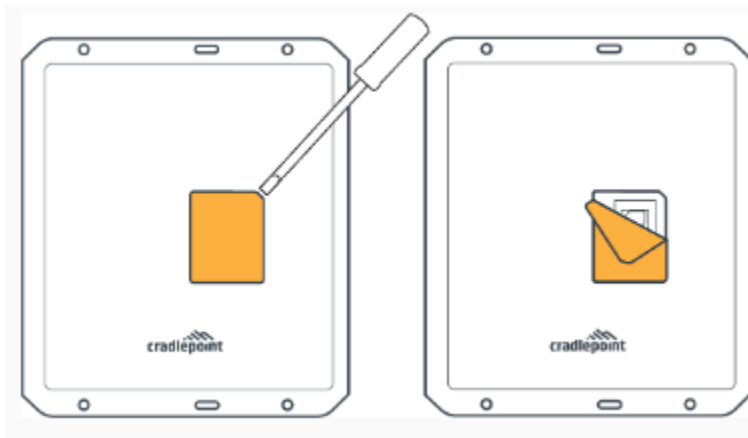

*Figure 4: R1900 Sticker*

- B. Align the port to the receiver and place the R1900 on top as shown in Figure 5. The receiver will only properly line up with the port in one direction. Reposition the R1900 until the two devices sit flush against each other and the screw holes are aligned:

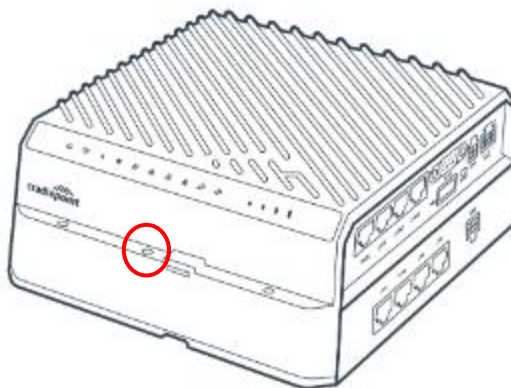

*Figure 5: R1900 and Accessory*

- C. Secure the two devices to each other with the Qty. 2: M3 screws. The screws must go in the middle screw holes on the front and rear of the connected devices.



**Step 3: Mount the router to the cover plate.**

- A. Place the Cover Plate on the Antenna Plate as shown in Figure 6 to allow access to the Router Plate.
- A. Remove the film from the display covers and apply to the cover plate as shown in Figure 7.
- B. Install the R1900 router onto the Managed Accessory. Insert the four PTA0757 screws into the Router and Accessory and slide the Router into the Router Module, as shown in Figure 8.
- C. Mount the router using the four PTA0140 Washers, four PTA0844 Lock Washers, and four PTA0408 Nuts provided in the kit, as shown in Figure 9.
- D. **Ensure the router orientation is correct as shown in the images below. The router display should be visible through the slot(s) in the cover plate.**



*Figure 6: Place the Cover Plate on the Antenna Plate.*

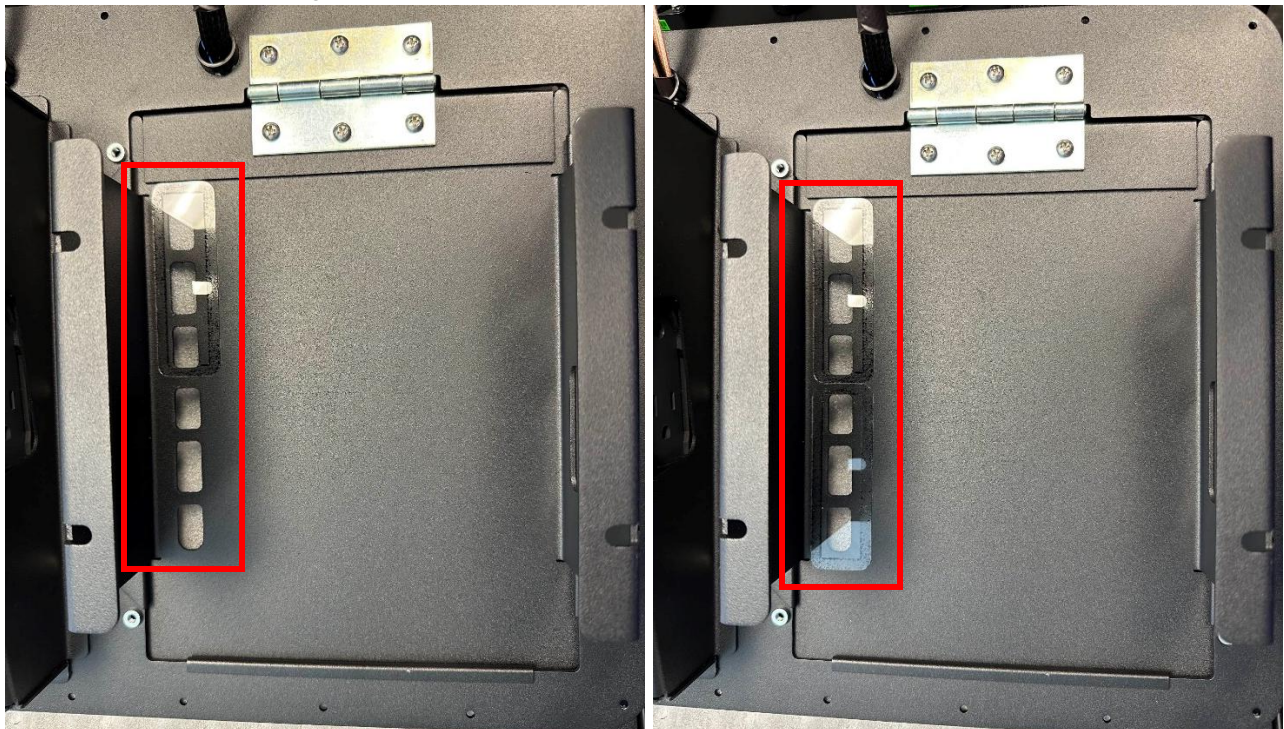

*Figure 7: Install the Display Covers on the Cover Plate.*



**Figure 8: Insert the R1900 Router into the Router Module.**

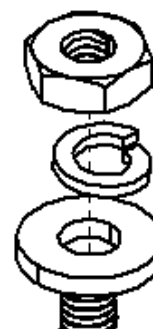

**PTA0408 Nut**

**PTA0844 Lock Washer**

**PTA0140 Washer**

**Figure 9: Mount the R1900 Router to the Cover Plate.**



## Connection:

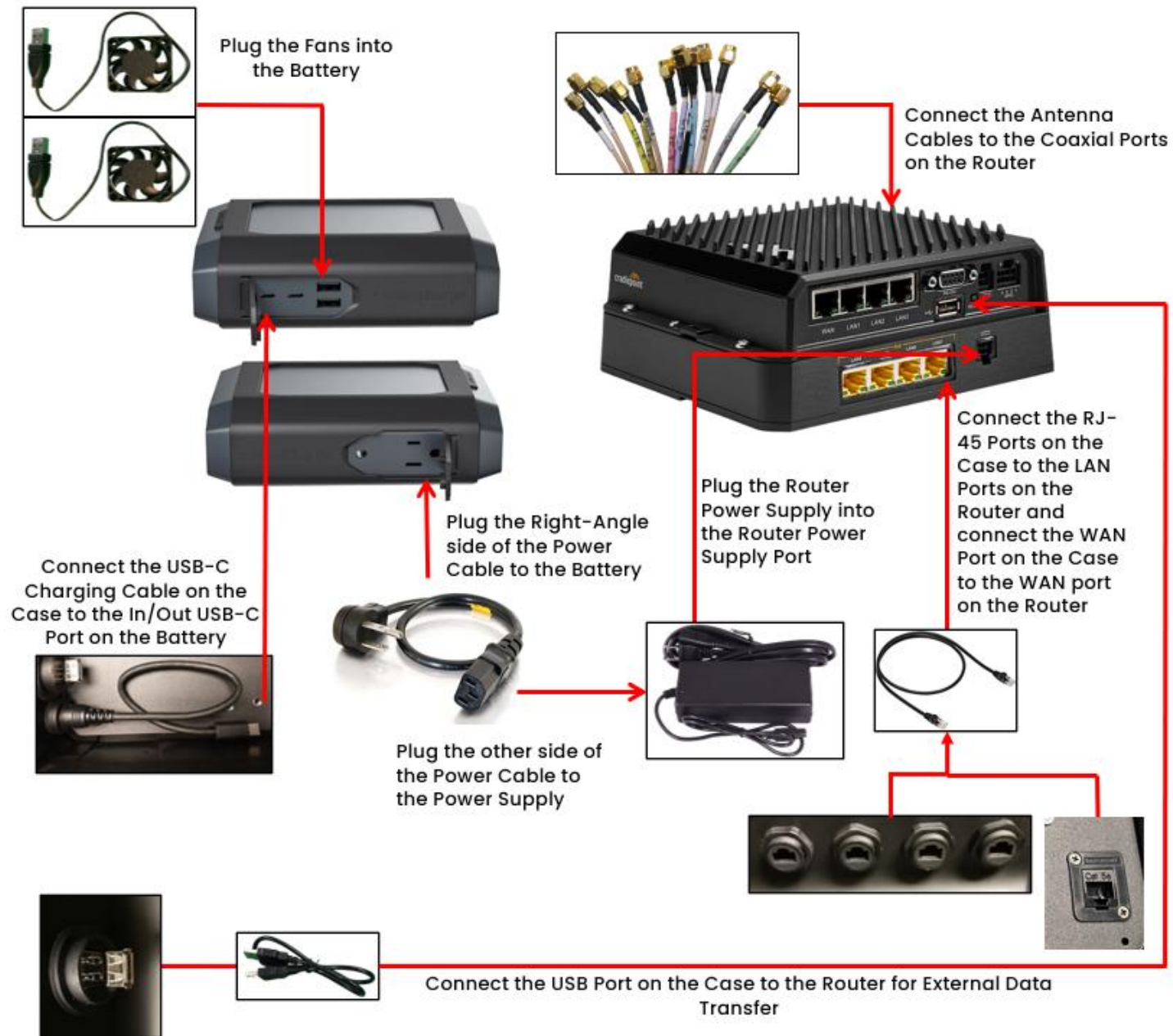

Figure 10: Connection Diagram for Bloodhound R19D

Step 1: Connect the antenna cables to the router.

- A. Use canned air or isopropyl alcohol to clean all the connectors to ensure that there is no dust in the terminals.
- B. Connect the antenna cables to the designated terminals on the router, as shown in the tables and images below.

Cradlepoint R1900	
Antenna Cable	Router Terminal
CELL 1	MAIN
CELL 2	DIV
CELL 3	MIMO1
CELL 4	MIMO2
CELL 5	MAIN 0 on modem
CELL 6	AUX 0 on modem
CELL 7	MAIN 1 on modem
CELL 8	AUX 1 on modem
GPS	GNSS
Wi-Fi 1	2.4/5GHz WIFI 1
Wi-Fi 2	2.4/5GHz WIFI 2
Bluetooth	BT



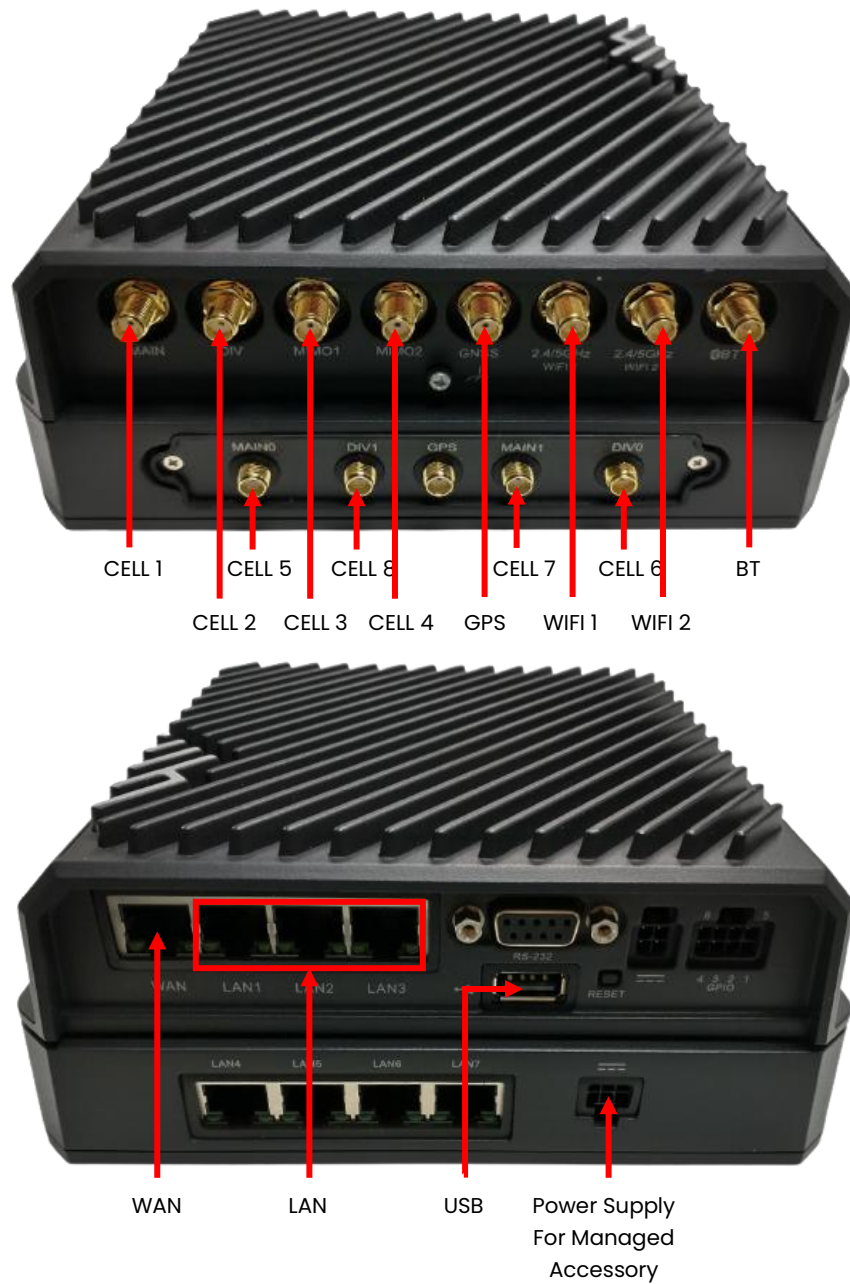

*Figure 11: Cradlepoint R1900 Connections*

Step 2: Connect the power supply to the router.

- A. Connect the router power supply to the power supply port on the managed accessory, shown in Figure 11.
- B. Plug the Right-Angle Power Cable into the Battery, shown in Figure 12.
- C. Connect the Power Cable to the Power Supply.
- D. Use cable ties and hook-and-loop straps to secure the router power supply to the bottom plate on the Case.



*Figure 12: Omnicharge Ultimate 38k Battery Pack Connections (Left Side).*

Step 3: Connect the fans to the battery.

- A. Plug the fan power cords into the USB-A ports on the battery, shown in Figure 13.
- B. This step has already been performed for the **Bloodhound R19DB**.



*Figure 13: Omnicharge Ultimate 38k Battery Pack Connections (Right Side).*

Step 4: Connect the router to the RJ-45 ports on the case using ethernet cords.

- A. Connect the provided ethernet cords to the LAN ports on the router, shown in Figure 11.
- B. Connect the other ends of the ethernet cords from the router to the RJ-45 ports on the case.
- C. Connect the provided ethernet cord to the WAN port on the router, shown in Figure 11.
- D. Connect the other end of the ethernet cord from the router to the RJ-45 port on the cover plate.

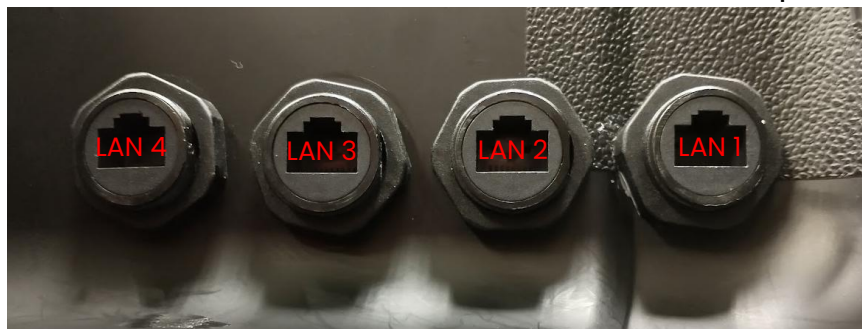

*Figure 14: Connect the router to the RJ-45 ports on the case using ethernet cords.*

Step 5: Connect the USB-A port on the case to the router.

- A. Connect one end of the provided USB-A cord into the USB-A port on the case.
- B. Connect the other end of the USB-A cord into the USB-A port on the router, shown in Figure 11.

Step 6: Connect the battery pack to the USB-C charging port on the case.

- A. Connect the USB-C charging port cable from the case to the USB-C port on the battery, shown in Figure 13.



# Final Assembly

Step 1: Make sure all the cables and devices are properly connected.

- A. Inspect every cable connection and ensure that no connections are loose.
- B. Use cable ties or other wire management to neatly bundle the cables **as shown below**. Ensure that the Antenna Cables are divided into two segments, as shown below, to ensure they do not press against the Power Adapter.

**Note: Ensure that the antenna cables are not excessively bent ( $1/2''$  minimum bend radius).**



Figure 15: Final Assembly

Step 2: Fasten the cover plate to the case.

- A. Place the cover plate onto the bottom half of the case. **Ensure that no cables are pinched between the cover plate and the case.**
- B. Fasten the cover plate to the case using the twenty-one PTA0351 black oval head screws with washers provided in the kit, as shown in Figure 146.



Figure 16: Fasten the cover plate to the case using PTA0351 screws.

# Operational Setup

Step 1: Open the fan and vent caps.

- A. Before turning the router ON, always open the fan and vent caps. The type of cap may vary.
- B. **Ensure that the antenna is away from any liquids when the caps are open.**



*Figure 17: Open the fan and vent caps.*

Step 2: Power on the router.

- A. Turn the battery pack ON by pressing and holding the power button for 3 seconds. The display on the battery pack will indicate the battery pack's current battery life (%).
- B. Set the AC output switch on the battery pack to ON.
- C. Shortly after turning on the battery pack, the fan will start.
- D. To charge the battery pack, connect the battery pack charger to the USB-C charging port on the back of the case.
- E. See Page 15 for Battery Operation and Safety Guidelines.



Step 3: Connect the router to a computer.

- A. Use an ethernet cable to connect a computer to one of the RJ-45 ports on the case that are connected to the LAN ports on the router.

Step 4: Login to Cradlepoint NetCloud.

- A. Open a web browser on the computer and type 192.168.0.1 into the address bar. This will bring up the Cradlepoint NetCloud login, shown in Figure 16.
- B. Login to Cradlepoint NetCloud. The username is "admin", and the password is found on the router, shown in Figure 17.

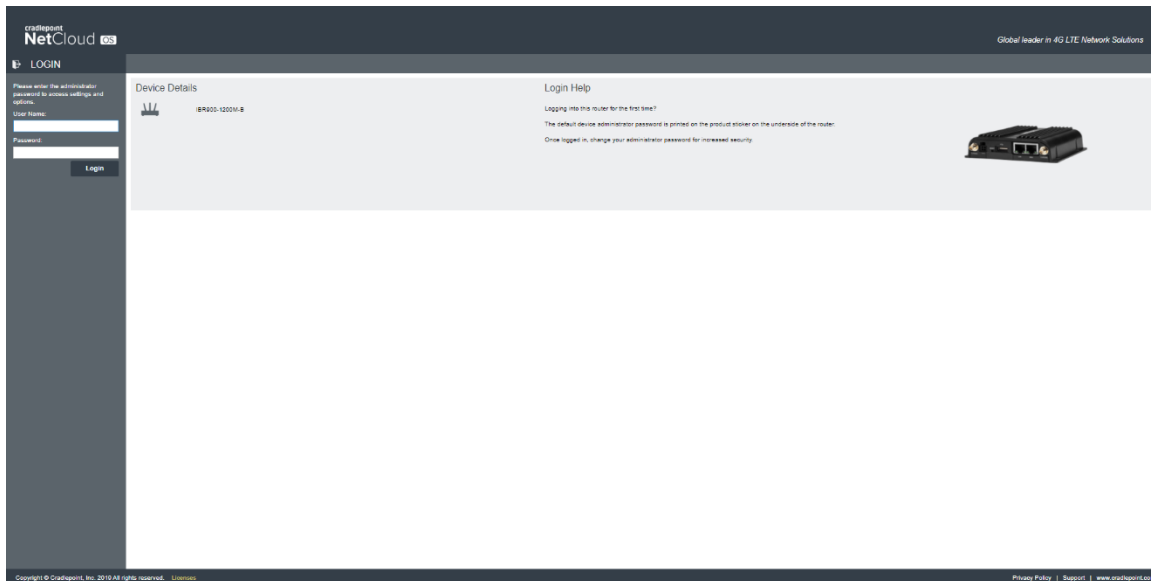

Figure 16: Access Cradlepoint NetCloud.

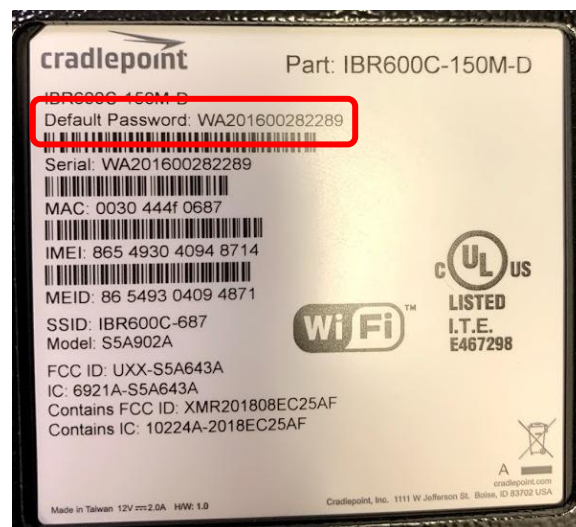

Figure 17: Cradlepoint NetCloud Login Password

Step 5: Select the router in the device list on Cradlepoint NetCloud.

- A. On the left side of the page, select STATUS. From the dropdown menu, select INTERNET and then CONNECTIONS.
- B. In the Device List table, select the option with a cellular SIM, as shown in Figure 18.

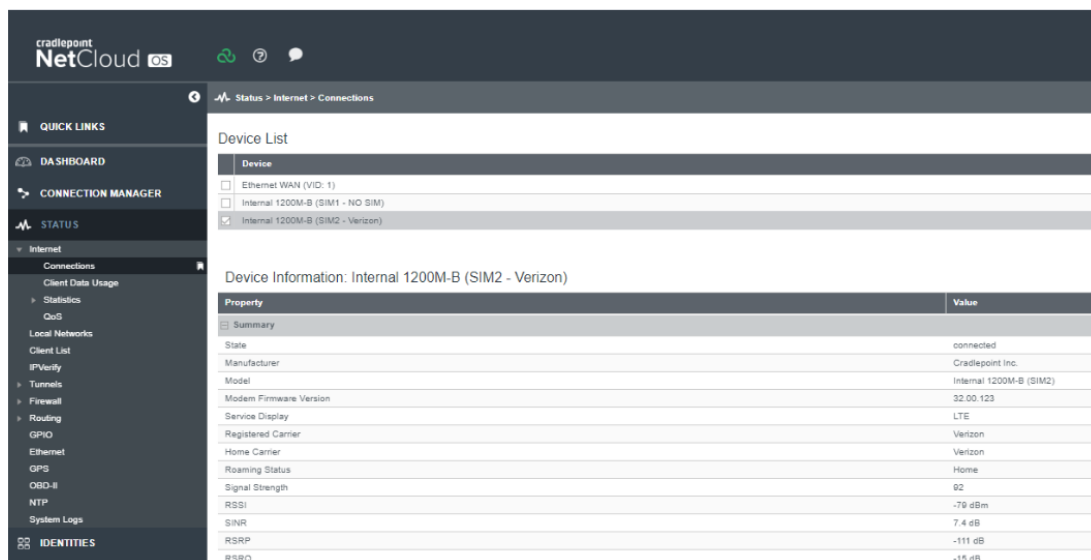



Figure 18: Select the device with a cellular SIM in Cradlepoint NetCloud.

## Antenna setup is complete!

For best antenna performance, operate the antenna with the lid closed and the case oriented with the lip on top.

Make sure the fan and vent caps are open while using the antenna.

# Battery Operation and Safety Guidelines

- A. To manually power ON/OFF, press and hold the power button  for 3 seconds. All LED lights/display should turn ON/OFF.
- B. Make sure the battery is at least 30% charged before operating. If the battery is not charged, charge the battery using the USB-C Port on the Case.
- C. Recharging the battery pack can be done with a Type-C PD Charger with at least 45W of power and up to 65W maximum.
- D. While plugged in and charging, the battery pack will allow pass-through charging to continue powering any devices that are plugged in to the battery pack.
- E. The battery will automatically shut off after 12 hours, regardless of user input.
- F. Warning: if the battery pack exceeds a safe operating temperature due to insufficient ventilation or a high-temperature environment, the unit will automatically shut OFF.
- G. **Keep out of reach of children.**
- H. **The product may become uncomfortably warm, reaching 104°F (40°C) under extended, high-power usage. While using the product, make sure to keep it away from materials that may be affected by high temperatures.**
- I. **Hold on carefully when inserting or removing a cable. Make sure not to force or bend cables when inserting them into the charging ports.**
- J. **Avoid inserting any foreign objects into the ports.**
- K. **Do not attempt to open, alter, or modify the unit.**
- L. **Do not operate in temperatures under 50°F (10°C) or over 104°F (40°C).**
- M. **Do not expose the product to wet conditions such as water, rain, or snow.**
- N. **Failure to follow these safety guidelines may cause personal injury and/or property damage to the product. It may also void the product warranty.**



# Disclaimer

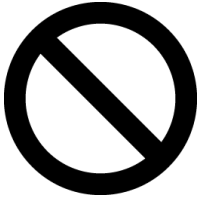

## CAUTION

To comply with FOC RF Exposure requirements in section 1.1310 of the FCC Rules, antennas used with this device must be installed to provide a separation distance of at least 20 cm from all persons to satisfy RF exposure compliance.



## DO NOT:

- Do not operate the transmitter when someone is within 24 inches of the antenna
- Do not install the antenna or mast assembly on a windy day
- Do not install the mast close to power lines as it can cause serious injuries or death



## WARNING

This document is for general information only. It cannot be used for a warranty. Performance and other data contained were obtained in internal lab tests under ideal conditions, and performance may vary due to network variables, different network environments and other conditions. Parsec Technologies Inc. will not accept any liability for any damage caused by an antenna due to unknown variables. Parsec Technologies Inc. reserves the right to change, modify, transfer, or otherwise revise this publication without notice, and the most current version of the publication will be applicable.

## Support Contact & Version #



Parsec Technologies  
972-804-4600  
support@parsec-t.com

Last Revised: 10.02.2025